

# MEC 3

SCARRABILE CON ARTICOLAZIONE E RIBALTAMENTO

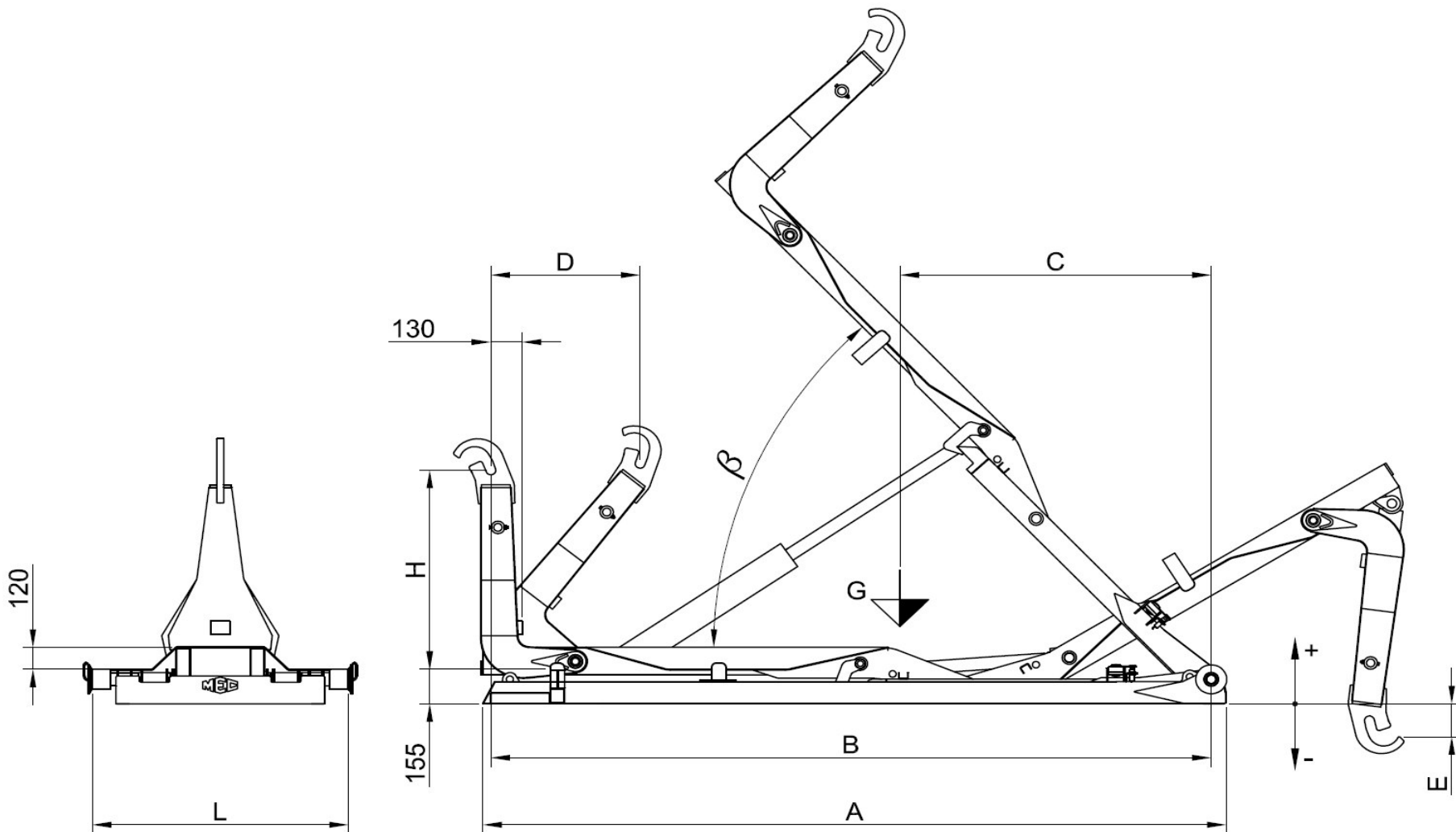

Modèle Equip	PTAC Minimum conseillée	Poids Equip	Angle	Debit conseillée de la pompe	Pression Max	Capacité maximale de charge	Dimensions						Caisson conseillé		
Equipment Model	Minimum GVW recommended	Equip Weight	Angle	Recomm. pump flow	Max Pressure	Maximum loading capacity	Dimensions						Recommended container		
Modello Scarrabile	PTT Minimo consigliato	Peso Scarr.	Angolo	Portata consigliata della pompa	Pressione Max	Capacità massima di carico	Dimensioni						Cassa consigliata		
	<b>TON</b>	<b>Kg</b>	<b>β</b>	<b>Litri / min</b>	<b>Bar</b>	<b>TON</b>	<b>A</b>	<b>B</b>	<b>C</b>	<b>D</b>	<b>H</b>	<b>E</b>	<b>L</b>	<b>MIN</b>	<b>MAX</b>
<b>MEC 3</b>	<b>3,5</b>	<b>470</b>	<b>47°</b>	<b>15</b>	<b>280</b>	<b>3</b>	<b>3100</b>	<b>3000</b>	<b>1850</b>	<b>625</b>	<b>900</b>	<b>- 150</b>	<b>1070</b>	<b>2500</b>	<b>3400</b>